

# Quick Start Guide

## Smart Wi-Fi Lamp Dimmer Kit

### Appearance

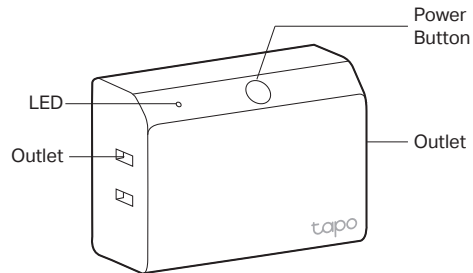

#### Outlets \*2

Connect lamps and control them simultaneously

#### Power Button

- **Touch once:** Turn on/off lamps
- **Touch and hold for 5s:** Reset Wi-Fi while preserving other existing settings
- **Touch and hold for 10s:** Reset to factory default settings

### 1 Download the Tapo App

Download the **Tapo** app from the App Store or Google Play.



### 2 Set Up with the Tapo App

Open the Tapo app. Select **Plugs** and then your model. Follow the app instructions to complete setup.

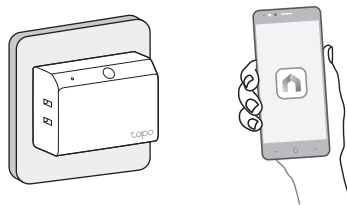

### 3 Connect Lamps

Connect lamps to the outlets and control them simultaneously.

#### For Device Safety

- ⚠ **Lamps only. Do NOT exceed the max load.**  
Total Max Load: 150W LED, 300W INC/HAL
- ⚠ **Do NOT connect products powered by power adapters.** This may damage the adapter and cause hazards.
- ⚠ **Not compatible with smart lights.**

#### Supported Dimming Type

TRIAC Dimming/Forward (Leading-edge) Phase Dimming  
\*It's also suggested to contact your bulb's Support to check the supported dimming type of the bulb.

#### For Optimal Dimming Performance

- ⚠ **Make sure the lights connected to the outlets are the same fixture type, support the same dimming type, and have the same load.**
- ⚠ **Bulbs may vary in their dimming range.** Recalibrate the brightness in the Tapo app after changing a bulb.

If the lights are too bright when dimming to the minimum level, or they flicker:

1. Check if the connected lights are the same brand and model.
2. Open the Tapo app and go to **Device Settings** to adjust the dimming range.

## 4 Use the Dimmer Button to Control Lights

Remove the battery insulation tab to power up your dimmer button. It will be paired with the dimmer automatically. You can tap or rotate the button to control the lights.

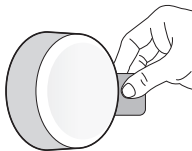

If you can't control the lights, try moving closer or manually pairing the button with the dimmer.

### How to pair manually:

- Unplug the dimmer and plug it back in.
- Within 20 seconds, press and hold the button for at least 5 seconds to start pairing.
- The LED on the dimmer will quickly flash green and orange, indicating a successful pairing.

(Optional) Attach the non-slip pad to the button to keep it firmly in place. Magnetically attach the button to metallic surfaces.

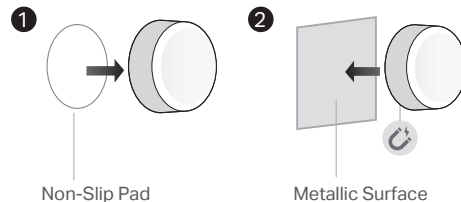

## How to Replace the Dimmer Button Battery

1

### Option 1: By Hand

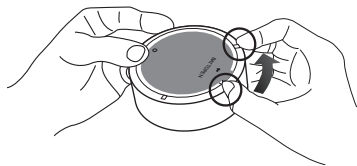

OR

### Option 2: With a Shim

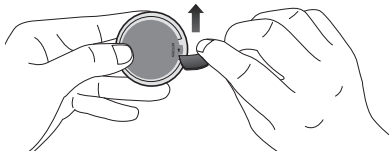

2

### Replace Battery (Battery Type: CR2032)

\*Make sure the battery is level and its positive side is facing up.

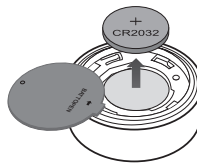

## Specifications

Rating: 120V~ 60Hz

Max Load: 150W LED, 300W INC/HAL

Operation Temperature: 32°F ~ 104°F

ELECTRONIC – DISCONNECTION (Type 1.Y)

Impulse Voltage: 1500V

Pollution Degree 2

### ⚠ CAUTION! (Safety Information)

RISK OF EXPLOSION IF BATTERY IS REPLACED BY AN INCORRECT TYPE  
DISPOSE OF USED BATTERIES ACCORDING TO THE INSTRUCTIONS

Do not ingest battery, Chemical Burn Hazard.

Keep new and used batteries away from children.

This product contains a coin / button cell battery. If the coin / button cell battery is swallowed, it can cause severe internal burns in just 2 hours and can lead to death.

If the battery compartment does not close securely, stop using the product and keep it away from children.

If you think batteries might have been swallowed or placed inside any part of the body, seek immediate medical attention. Avoid replacement of a battery with an incorrect type that can defeat a safeguard.

Avoid disposal of a battery into fire or a hot oven, or mechanically crushing or cutting of a battery, that can result in an explosion.

The battery must be removed from the CONTROL before it is scrapped.

The battery is to be disposed of safely. Do not leave a battery in an extremely high temperature surrounding environment

that can result in an explosion or the leakage of flammable liquid or gas; Do not leave a battery subjected to extremely low air pressure that may result in an explosion or the leakage of flammable liquid or gas.

Stop using the dimmer button if the battery leaks in the battery compartment. In the event of a battery leaking, do not allow the liquid to come in contact with the skin or eyes. If contact has been made, wash the affected area with copious amounts of water and seek medical advice.

Keep the device away from water, fire, humidity or hot environments.

Do not attempt to disassemble, repair, or modify the device. If you need service, please contact us.

Do not use the device where wireless devices are not allowed.

Do not plug in a row: devices of the same or another type not be stacked in normal use.



Semiconductor switch: The lamp is completely powered off only when it is pulled out from the socket of this product.

Please read and follow the above safety information when operating the device. We cannot guarantee that no accidents or damage will occur due to improper use of the device. Please use this product with care and operate at your own risk.

?

### Need some help?

Visit <https://www.tapo.com/support/> for technical support, the user guide, FAQs, warranty & more